

STATO M F128

As of: April 19, 2024

| Description | Model | Carton Quantity |
|-------------|-------|--------------------|
| STATO-M | F128 | 100 pcs per Carton |

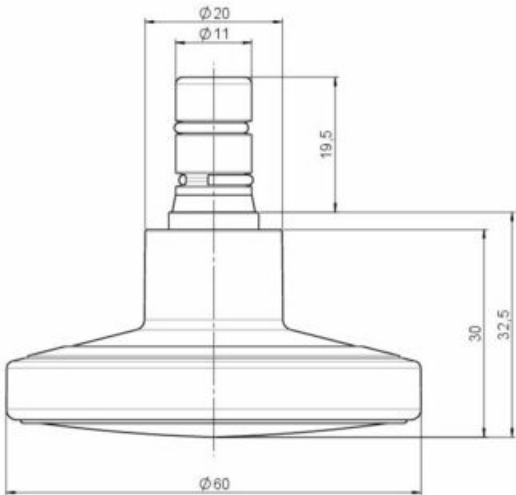

Technical Details

| | |
|----------------------------|--|
| Product Type | Glide |
| Glide bottom diameter | 60mm |
| Load capacity | 80kg |
| Overall height with fixing | 32,5mm |
| Housing: | |
| Bottom | standardconvex bottom |
| Upper glide material | High quality plastic |
| Upper glide color | RAL 9005 Jet black with middle ring in Shiny chrome |
| Lower glide material | High quality plastic |
| Lower glide color | RAL 9005 Jet black |
| Fixing | No-Noise™ Stem, 11x19,5mm Push fit stem with double circlips, 11,4mm |
| Description | F 128 BG1X2NN |

Fixings

Compatible with the following available fixings:

No-Noise™ Stem:

- 11x19.5mm with 11.4mm circlip
- 11x19.5mm with 11.6mm circlip

Push fit stems:

- 10x22mm with 10.3mm circlip
- 10x22mm with 10.5mm circlip
- 11x19.5mm with 11.4mm circlip
- 11x19.5mm with 11.8mm circlip
- 11x22mm with 11.4mm circlip
- 11x22mm with 11.6mm circlip
- 11x22mm with 11.8mm circlip

Threaded stems:

- M8x15mm
- M8x25mm
- M10x15mm
- M10x25mm
- 5/16-18x5/8"
- 3/8-16x5/8"
- 3/8-16x1/2"
- 3/8-16x1"

Square plates:

- 38x38mm
- 55x55mm
- 60x60mm