

STATO F001

As of: April 25, 2024

Description	Model	Carton Quantity
F 1 BG 1X10	F001	100 pcs per Carton

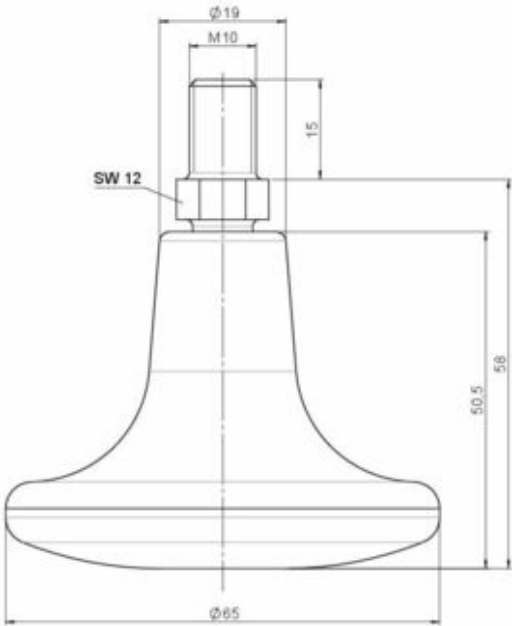

Technical Details

Product Type	Glide
Glide bottom diameter	65mm
Load capacity	75kg
Overall height with fixing	58mm
<b>Housing:</b>	
Bottom	standard
Upper glide material	Zinc die-cast
Upper glide color	Shiny chrome
Lower glide material	High quality plastic
Lower glide color	Other
Fixing	Standard, M10x15mm Threaded stem, without circlip
Description	F 1 BG 1X10

## Fixings

Compatible with the following available fixings:

### No-Noise™ Stem:

- 11x19.5mm with 11.4mm circlip
- 11x19.5mm with 11.6mm circlip

### Push fit stems:

- 10x22mm with 10.3mm circlip
- 10x22mm with 10.5mm circlip
- 11x19.5mm with 11.4mm circlip
- 11x19.5mm with 11.8mm circlip
- 11x22mm with 11.4mm circlip
- 11x22mm with 11.6mm circlip
- 11x22mm with 11.8mm circlip

### Threaded stems:

- M8x15mm
- M8x25mm
- M10x15mm
- M10x25mm
- 5/16-18x5/8"
- 3/8-16x5/8"
- 3/8-16x1/2"
- 3/8-16x1"

### Square plates:

- 38x38mm
- 55x55mm
- 60x60mm