

Traditional 50 Single Wheel

As of: May 10, 2025

|                                    |                      |   |
|------------------------------------|----------------------|---|
| <b>Description</b><br>SW50-2X2AN35 | <b>Model</b><br>SW50 | <b>Carton Quantity</b><br>100 pc per carton |
|------------------------------------|----------------------|---|

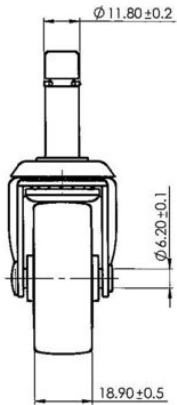
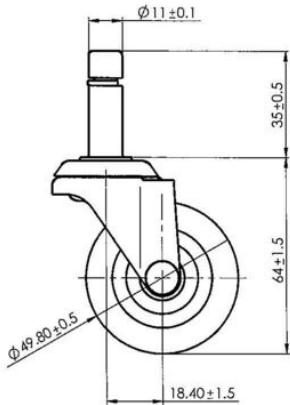

Technical Details

|                            |                       |
|----------------------------|-----------------------|
| Product Type               | Furniture caster      |
| Wheel diameter             | 50mm   2"             |
| Load capacity              | 34kg   75 lbs.        |
| Overall height with fixing | 66mm                  |
| <b>Wheel:</b>              |                       |
| Wheel type                 | hardwheel             |
| Wheel color                | Black                 |
| <b>Housing:</b>            |                       |
| Housing form               | unhooded              |
| Housing material           | Galvanized steel      |
| Housing color              | Chrome                |
| Mobility concept           | Freewheel             |
| Fixing                     | 11X35mm Push-fit stem |
| Description                | SW50-2X2AN35          |

## Fixings

Compatible with the following available fixings:

### Push fit stems:

- 10x20mm with 10.3mm circlip
- 10x22mm with 10.5mm circlip
- 11x19.5mm with 11.8mm circlip
- 11x22mm with 11.4mm circlip
- 11x22mm with 11.6mm circlip
- 11x22mm with 11.8mm circlip
- 11x22mm with 11.8 banded K290 4A
- 11x26mm

### Threaded stems:

- 3/8-16x1"
- 3/8x1"

### Square plates:

- 38x38mm
- 55x55mm
- 60x60mm