

Standard D375

As of: June 26, 2026

| Description     | Model | Carton Quantity   |
|-----------------|-------|-------------------|
| DUZB375 - 2 X10 | D375  | 60 pcs per Carton |

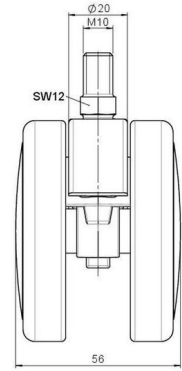
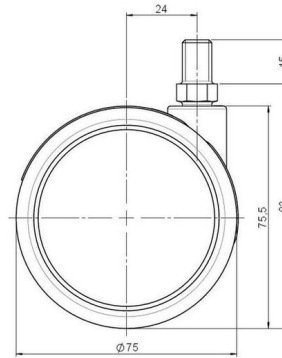

## Technical Details

|                            |   |
|----------------------------|---|
| Product Type               | Furniture caster                          |
| Wheel diameter             | 75mm   3"                                 |
| Load capacity              | 75kg   165 lbs.                           |
| Overall height with fixing | 83mm                                      |
| <b>Wheel:</b>              |   |
| Wheel type                 | Soft wheel                                |
| Wheel core / tread color   | RAL 9010 Pure white / RAL 9010 Pure white |
| <b>Housing:</b>            |   |
| Housing form               | unhooded, with neck diameter              |
| Neck diameter              | 20mm                                      |
| Housing material           | Zinc die-cast                             |
| Housing color              | RAL 9010 Pure white                       |
| Mobility concept           | Freewheel                                 |
| Fixing                     | M10x15mm Threaded stem                    |
| Description                | DUZB375 - 2 X10                           |

## Fixings

Compatible with the following available fixings:

### No-Noise™ Stem:

- 11x19.5mm with 11.4mm circlip
- 11x19.5mm with 11.6mm circlip

### Push fit stems:

- 10x22mm with 10.3mm circlip
- 10x22mm with 10.5mm circlip
- 11x19.5mm with 11.4mm circlip
- 11x19.5mm with 11.8mm circlip
- 11x22mm with 11.4mm circlip
- 11x22mm with 11.6mm circlip
- 11x22mm with 11.8mm circlip
- 11x22mm with 11.8 banded K290 4A
- 11x26mm

### Threaded stems:

- M8x15mm
- M8x20mm
- M8x25mm
- M10x15mm
- M10x20mm
- M10x25mm
- M10x30mm
- M10x40mm
- M12x20mm
- 5/16-18x1"
- 5/16-18x1/2"
- 3/8-16x1"
- 5/16-18x5/8"
- 3/8-16x1/2"
- 3/8-16x5/8"

### Square plates:

- 38x38mm
- 55x55mm
- 60x60mm